

2x6 ON FLAT CROSS-BRACING TO BRACED WEB AT INTERVAL NOT EXCEEDING 28'-0" o.c. (AND AT END OF RUN OF TRUSSES/END OF BUILDING). BRACING MATERIAL TO BE SUPPLIED AND INSTALLED BY ERECTION CONTRACTOR.

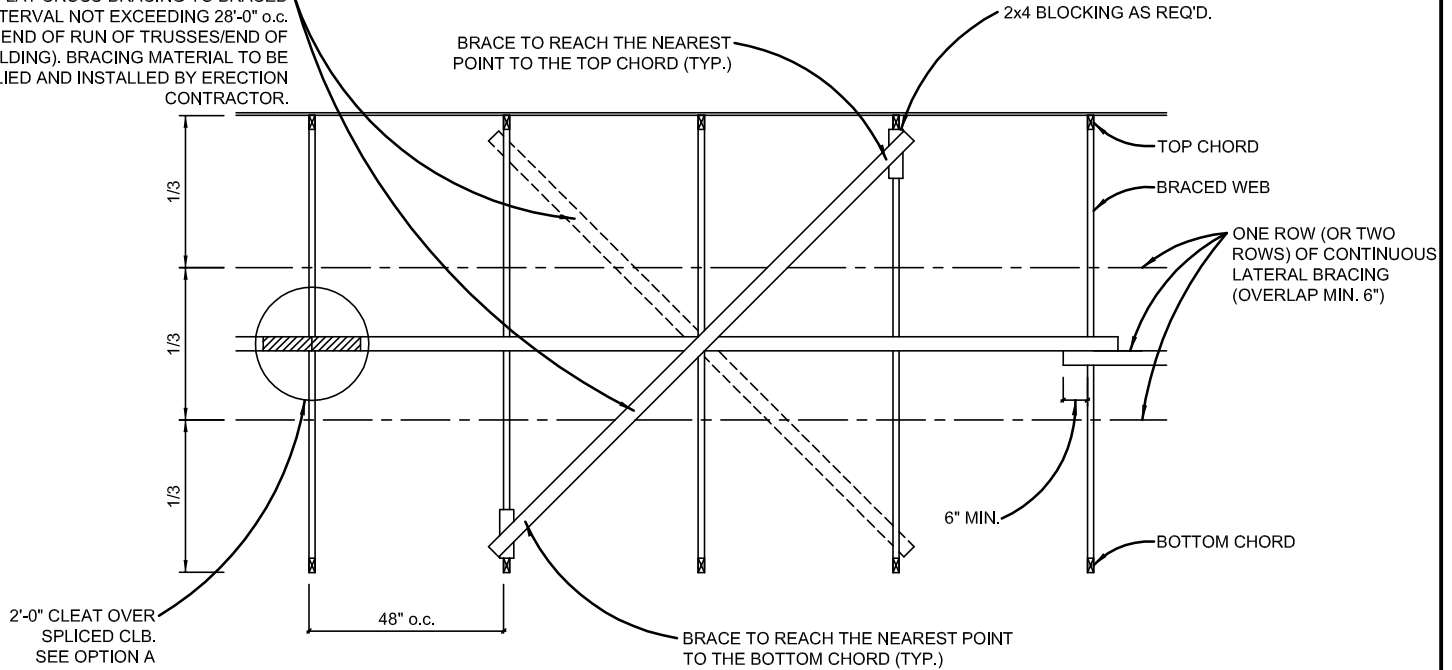

NOTES:

1. CROSS-BRACING TO BE AT THE SAME PLANE AS THE BRACED WEB.
2. CROSS-BRACING TO CROSS OVER MINIMUM 3 TRUSSES TO ACHIEVE APPROXIMATE 45° ANGLE.
3. USE MINIMUM 3 - 3" COMMON NAILS TO INTERSECTION OF BRACE TO EACH CONT. LATERAL BRACING AND EACH TRUSS (PROVIDE BLOCKING WHERE REQUIRED).

FARM CROSS BRACING DETAIL

NOT TO SCALE

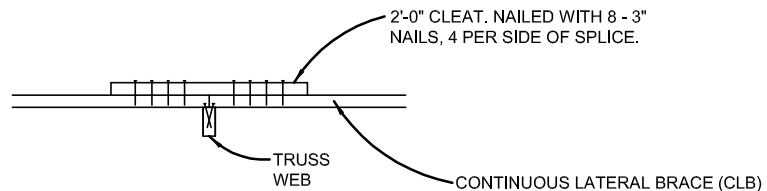

OPTION A

NOT TO SCALE